

Thrust 1 - Standard Stage

Stalls Seating: 126; Circle Seating: 73

Total Seating: 199

The Park Theatre, Clifton Terrace, N4	Studio 2 60 High Street Hampton Wick Surrey KT1 4DB
Park 200 - Stalls Plan Thrust 1	T 020 8977 8108 W dharchitects.co.uk E mail@dharchitects.co.uk
1:50 @A3	david hughes architects
Feb' 13	
0437 750 P1	

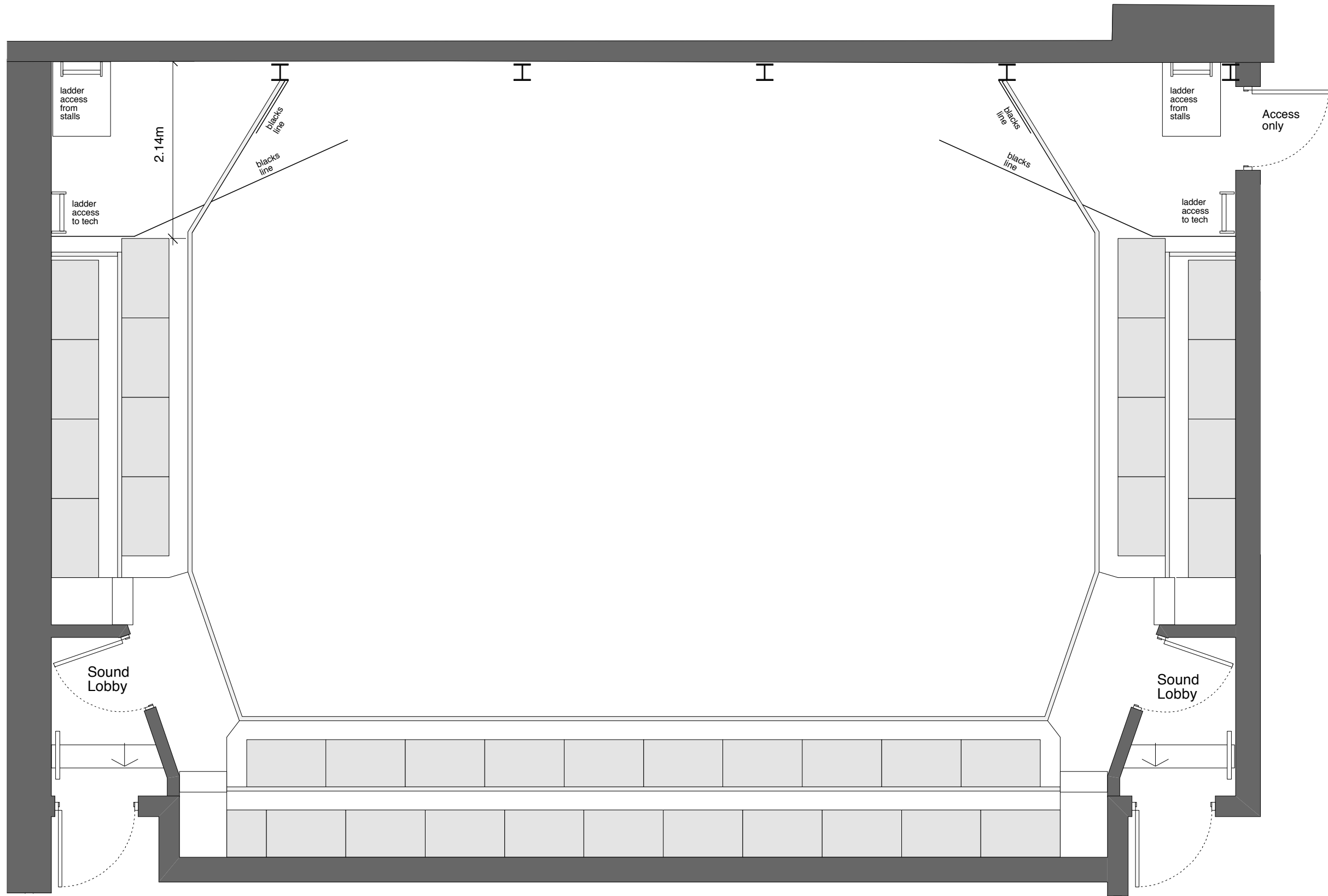

Thrust configuration

Circle Seating: 73

<p>The Park Theatre, Clifton Terrace, N4</p>	<p>Studio 2 60 High Street Hampton Wick Surrey KT1 4DB</p>
<p>Park 200 - Circle Plan Thrust 1</p>	<p>T 020 8977 8108 W dharchitects.co.uk E mail@dharchitects.co.uk</p>
<p>1:50 @A3</p>	
<p>Feb' 13</p>	<p>david hughes architects</p>
<p>0437 751</p>	<p>P1</p>

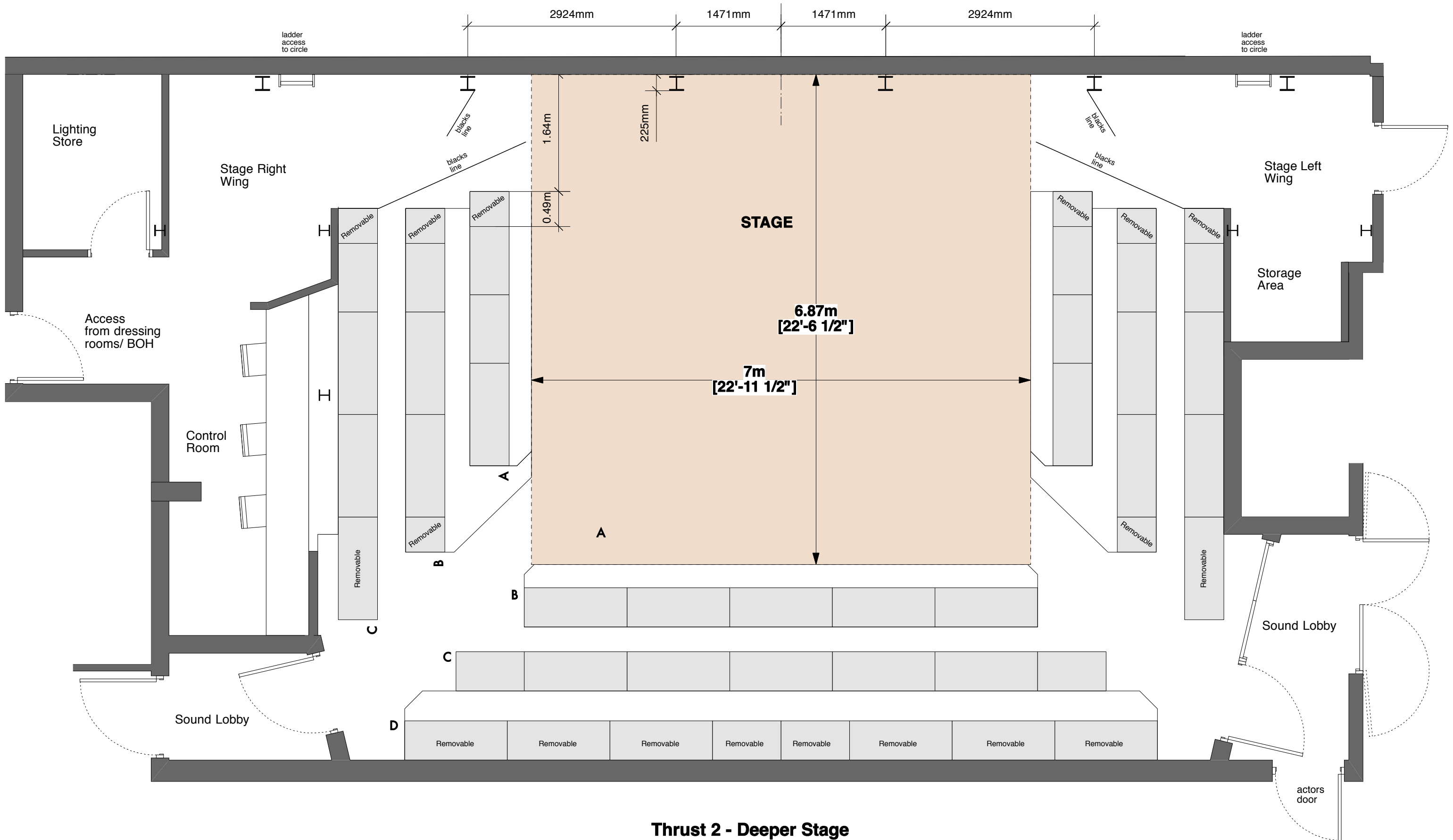

Thrust 2 - Deeper Stage

Stalls Seating: 116; Circle Seating: 73

Total Seating: 189

<p>The Park Theatre, Clifton Terrace, N4</p>	<p>Studio 2 60 High Street Hampton Wick Surrey KT1 4DB</p>
<p>Park 200 - Stalls Plan Thrust 2</p>	<p>T 020 8977 8108 W dharchitects.co.uk E mail@dharchitects.co.uk</p>
<p>1:50 @A3</p>	<p>david hughes architects</p>
<p>Feb' 13</p>	
<p>0437 752 P1</p>	

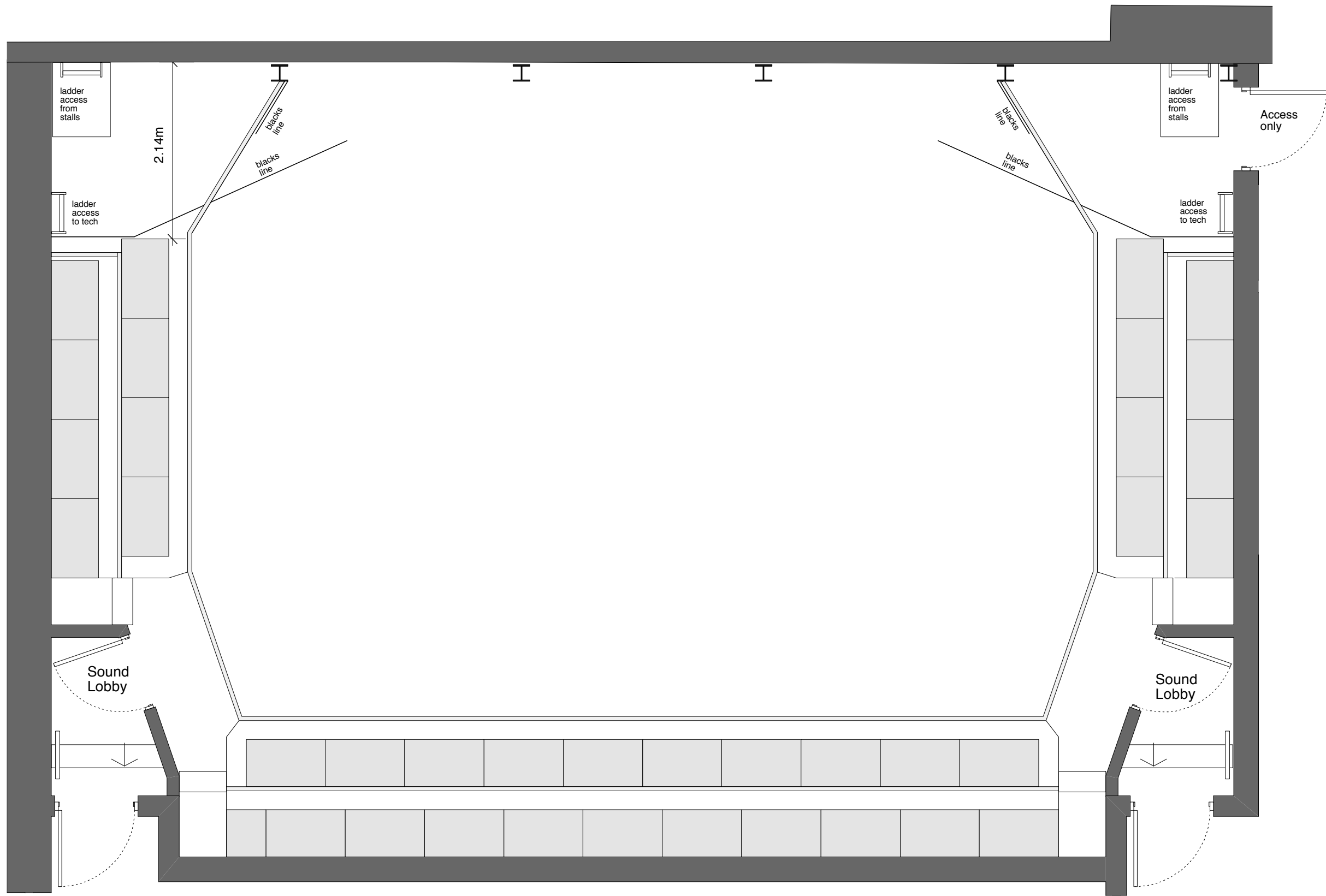

Thrust configuration

Circle Seating: 73

<p>The Park Theatre, Clifton Terrace, N4</p>	<p>Studio 2 60 High Street Hampton Wick Surrey KT1 4DB</p>
<p>Park 200 - Circle Plan Thrust 2</p>	<p>T 020 8977 8108 W dharchitects.co.uk E mail@dharchitects.co.uk</p>
<p>1:50 @A3</p>	
<p>Feb' 13</p>	<p>david hughes architects</p>
<p>0437 753</p>	<p>P1</p>

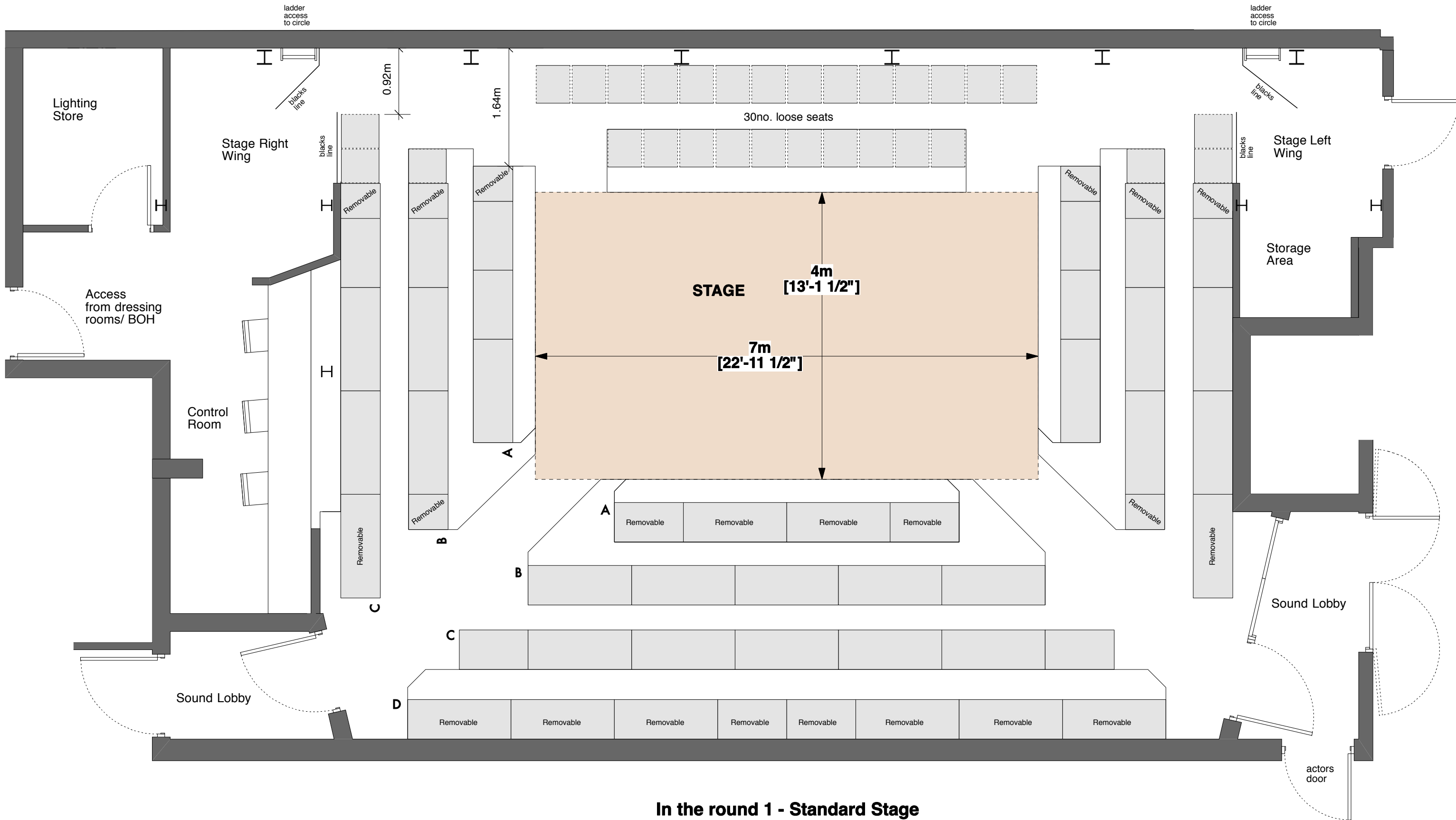

In the round 1 - Standard Stage

Stalls Seating: 156; Circle Seating: 81

Total Seating: 237

<p>The Park Theatre, Clifton Terrace, N4</p>	<p>Studio 2 60 High Street Hampton Wick Surrey KT1 4DB</p>
<p>Park 200 - Stalls Plan In the Round 1</p>	<p>T 020 8977 8108 W dharchitects.co.uk E mail@dharchitects.co.uk</p>
<p>1:50 @A3</p>	<p>david hughes architects</p>
<p>Feb' 13</p>	
<p>0437 754 P1</p>	

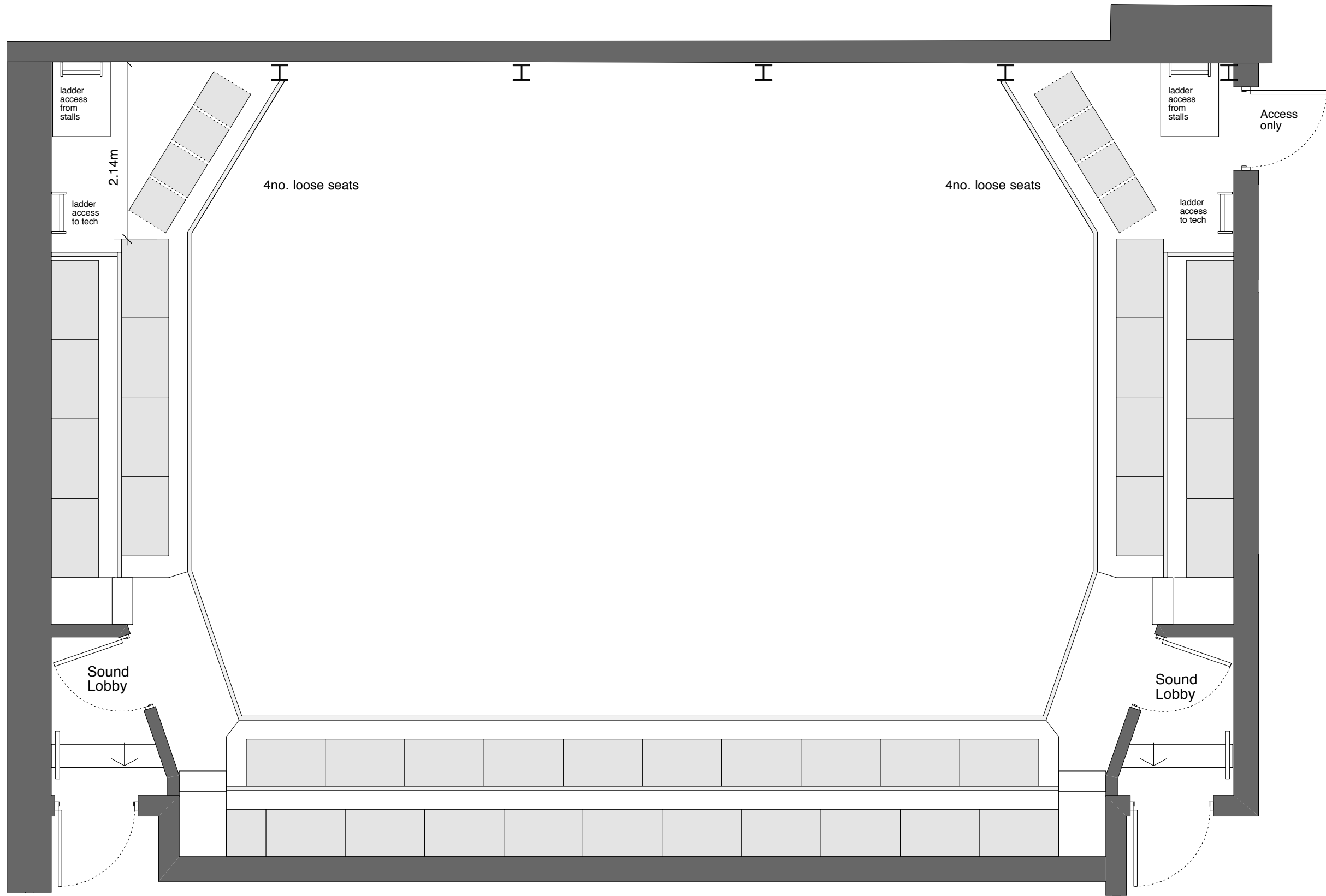

In the round configuration

Circle Seating: 81

<p>The Park Theatre, Clifton Terrace, N4</p>	<p>Studio 2 60 High Street Hampton Wick Surrey KT1 4DB</p>
<p>Park 200 - Circle Plan In the Round 1</p>	<p>T 020 8977 8108 W dharchitects.co.uk E mail@dharchitects.co.uk</p>
<p>1:50 @A3</p>	
<p>Feb' 13</p>	<p>david hughes architects</p>
<p>0437 755 P1</p>	

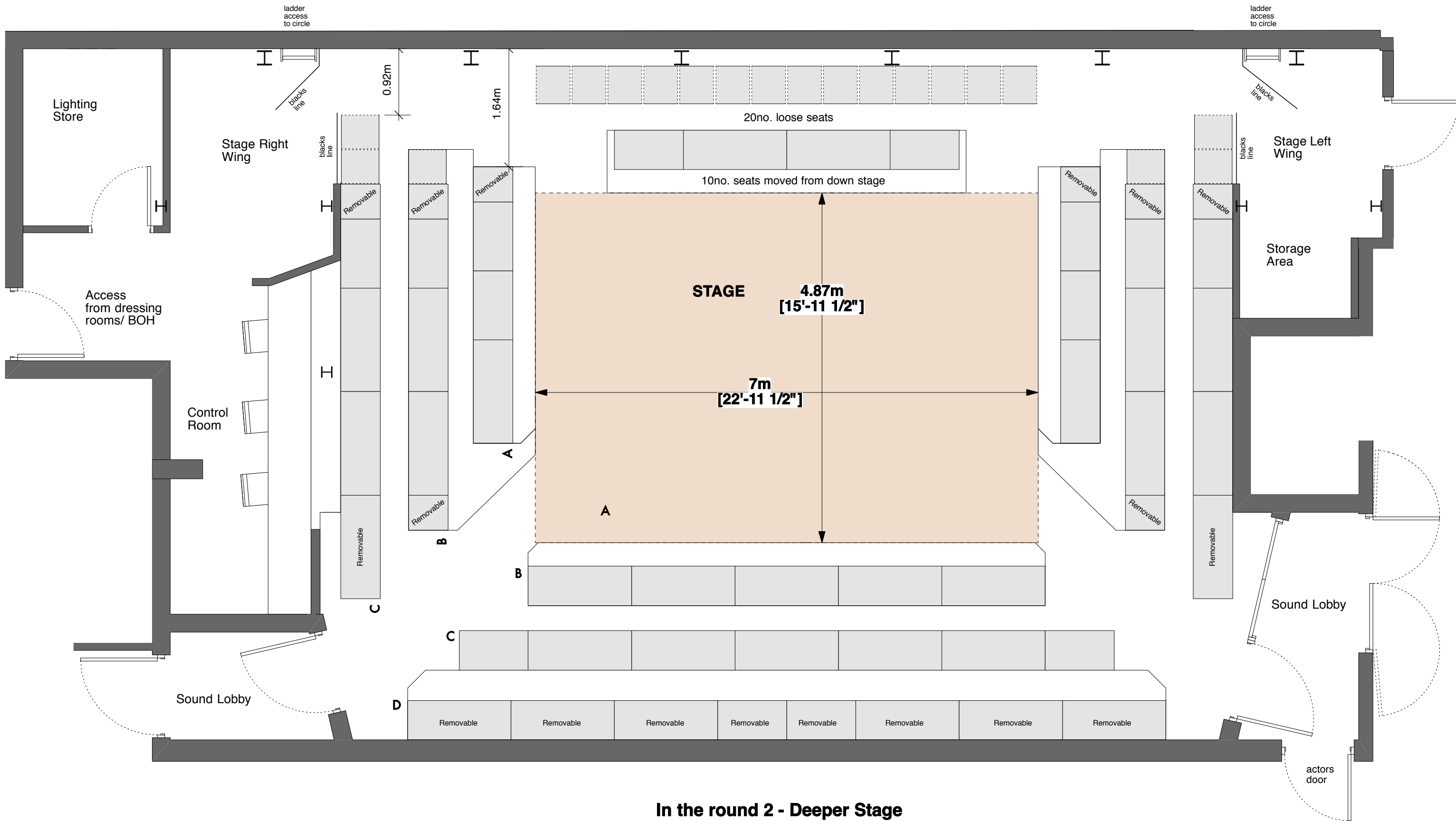

In the round 2 - Deeper Stage

Stalls Seating: 146; Circle Seating: 81

Total Seating: 227

<p>The Park Theatre, Clifton Terrace, N4</p>	<p>Studio 2 60 High Street Hampton Wick Surrey KT1 4DB</p>
<p>Park 200 - Stalls Plan In the Round 2</p>	<p>T 020 8977 8108 W dharchitects.co.uk E mail@dharchitects.co.uk</p>
<p>1:50 @A3</p>	<p>david hughes architects</p>
<p>Feb' 13</p>	
<p>0437 756 P1</p>	

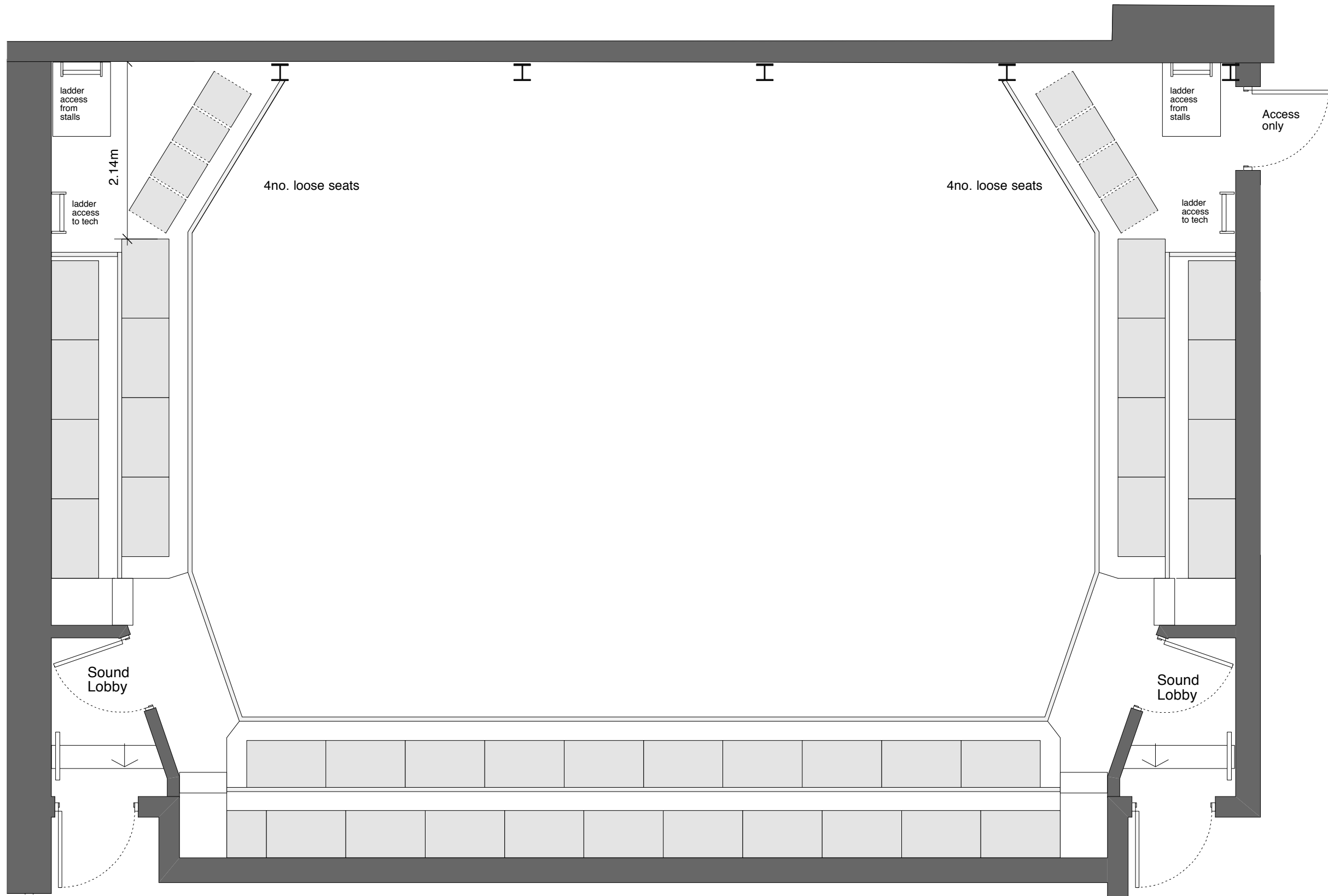

In the round configuration

Circle Seating: 81

<p>The Park Theatre, Clifton Terrace, N4</p>	<p>Studio 2 60 High Street Hampton Wick Surrey KT1 4DB</p>
<p>Park 200 - Circle Plan In the Round 2</p>	<p>T 020 8977 8108 W dharchitects.co.uk E mail@dharchitects.co.uk</p>
<p>1:50 @A3</p>	
<p>Feb' 13</p>	<p>david hughes architects</p>
<p>0437 757</p>	<p>P1</p>

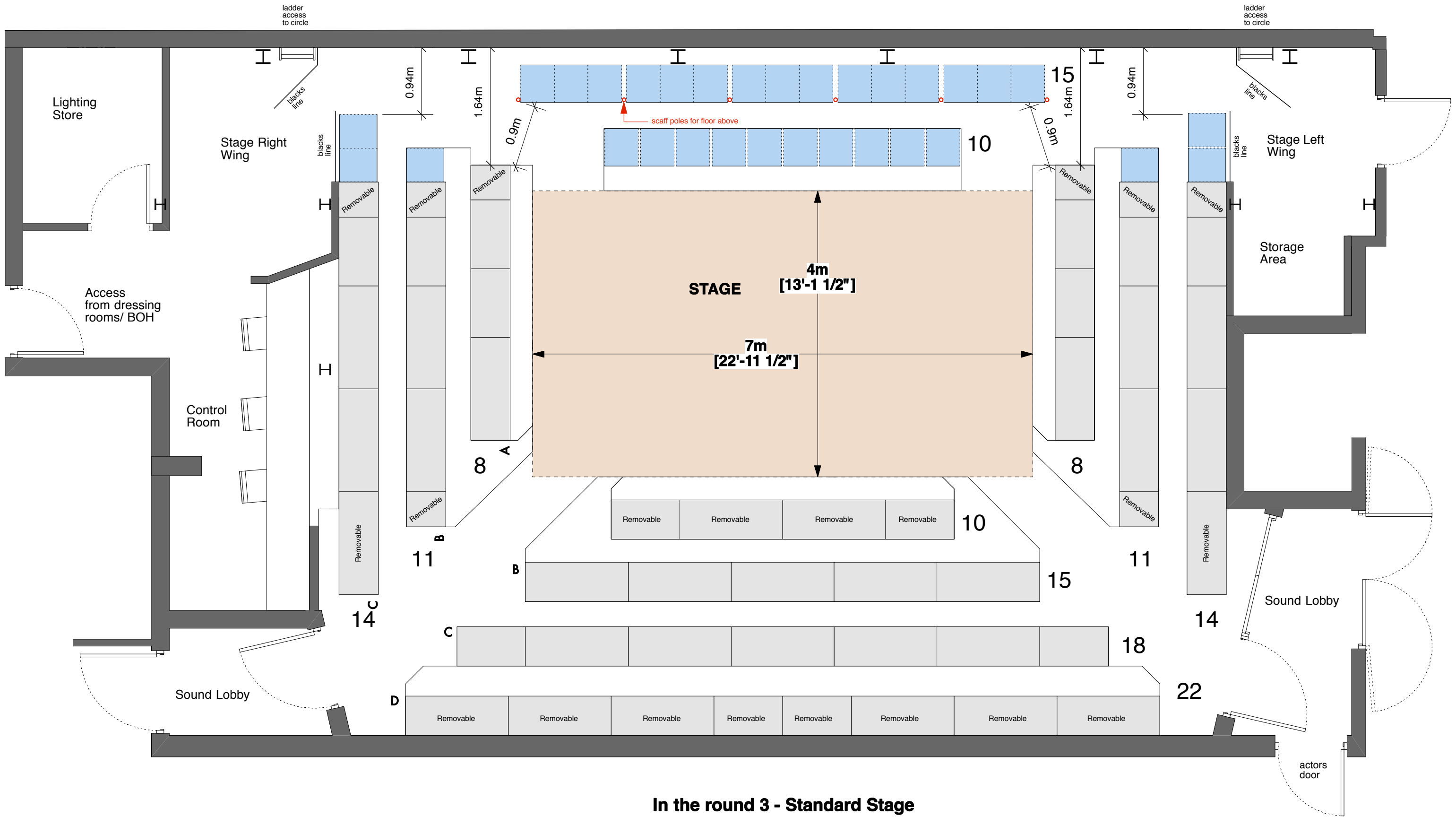

In the round 3 - Standard Stage

Stalls Seating: 156; Circle Seating: 96

Total Seating: 252

Note - blue seats are Sandler seats from Morris Space or Park 90 (54 total)

The Park Theatre, Clifton Terrace, N4		Studio 2 60 High Street Hampton Wick Surrey KT1 4DB
Park 200 - Stalls Plan In the Round 3		T 020 8977 8108 W dharchitects.co.uk E mail@dharchitects.co.uk
1:50 @A3		david hughes architects
Aug 14		
0437 758	P2	

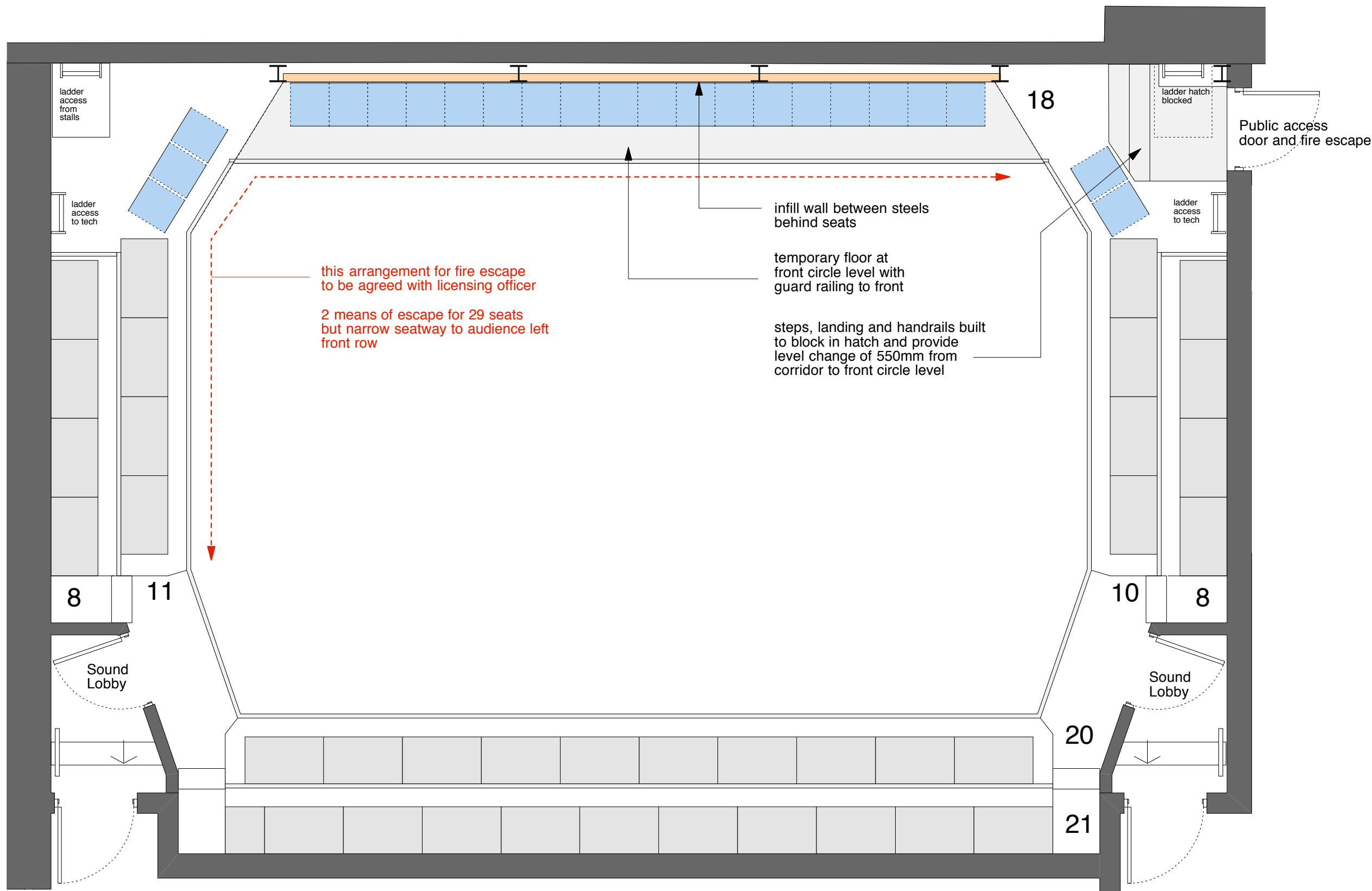

In the round configuration

Circle Seating: 96

<p>The Park Theatre, Clifton Terrace, N4</p>	<p>Studio 2 60 High Street Hampton Wick Surrey KT1 4DB</p>
<p>Park 200 - Circle Plan In the Round 3</p>	<p>T 020 8977 8108 W dharchitects.co.uk E mail@dharchitects.co.uk</p>
<p>1:50 @A3</p>	<p>david hughes architects</p>
<p>Aug 14</p>	
<p>0437 759 P2</p>	

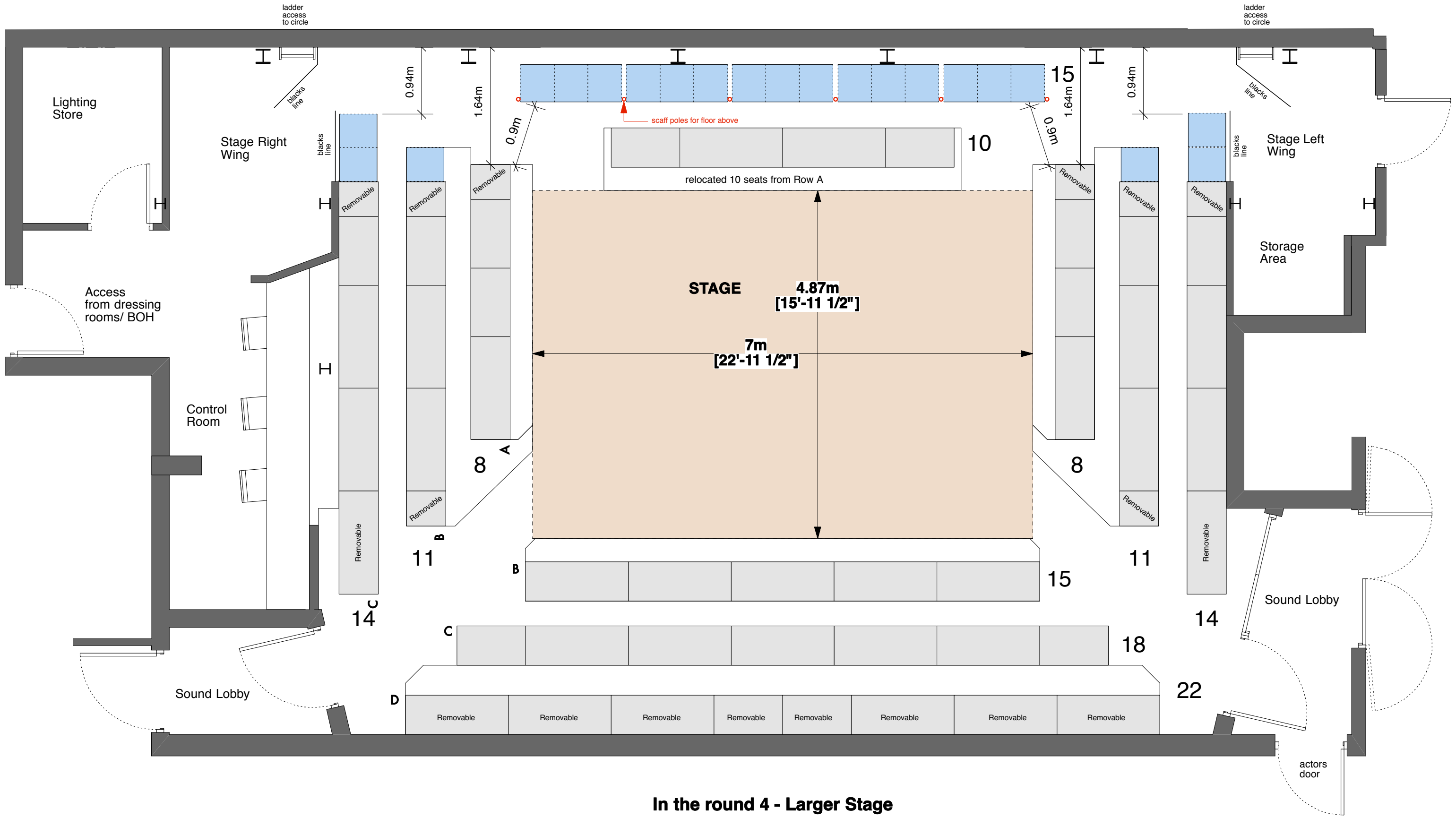

In the round 4 - Larger Stage

Stalls Seating: 146; Circle Seating: 96

Total Seating: 242

Note - blue seats are Sandler from Morris Space or Park 90 (44 total)

<p>The Park Theatre, Clifton Terrace, N4</p>	<p>Studio 2 60 High Street Hampton Wick Surrey KT1 4DB</p>
<p>Park 200 - Stalls Plan In the Round 4</p>	<p>T 020 8977 8108 W dharchitects.co.uk E mail@dharchitects.co.uk</p>
<p>1:50 @A3</p>	<p>david hughes architects</p>
<p>Aug 14</p>	
<p>0437 760 P2</p>	

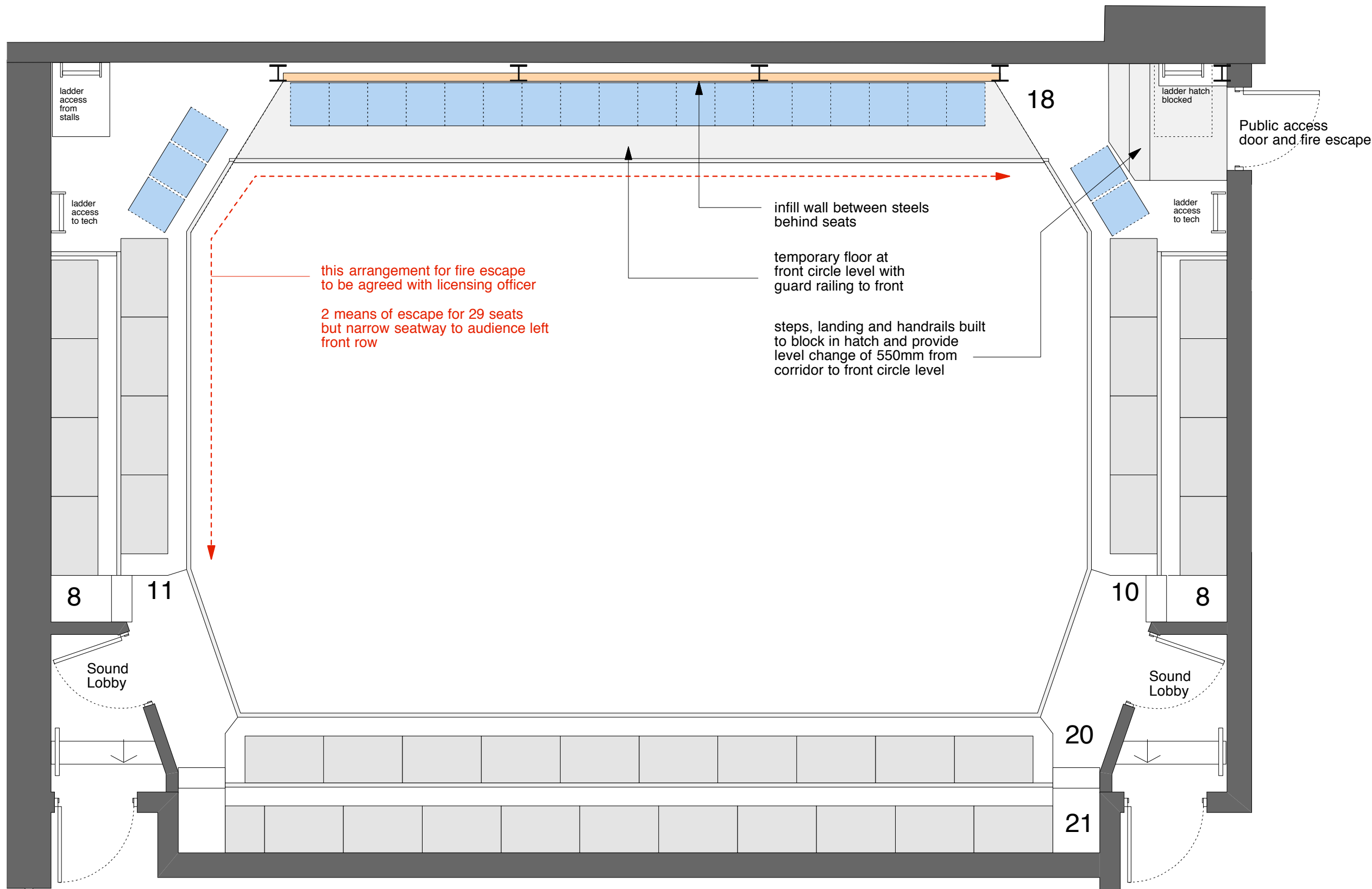

In the round configuration

Circle Seating: 96

The Park Theatre, Clifton Terrace, N4	Studio 2 60 High Street Hampton Wick Surrey KT1 4DB
Park 200 - Circle Plan In the Round 4	T 020 8977 8108 W dharchitects.co.uk E mail@dharchitects.co.uk
1:50 @A3	david hughes architects
Aug 14	
0437 761 P2	

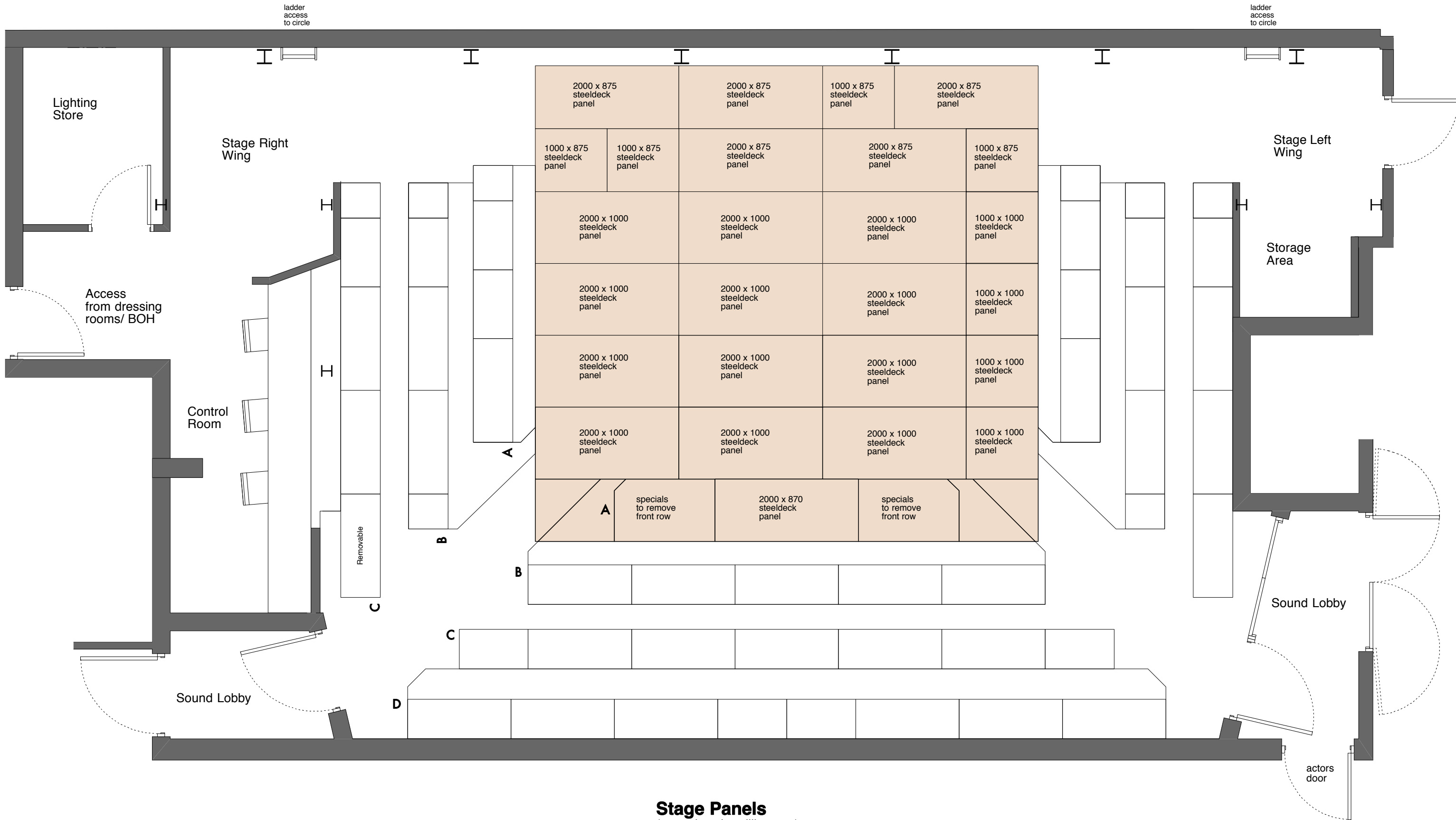

Stage Panels
(note sizes in millimeters)

The Park Theatre, Clifton Terrace, N4	Studio 2 60 High Street Hampton Wick Surrey KT1 4DB
Park 200 - Stalls Plan Stage Panels	T 020 8977 8108 W dharchitects.co.uk E mail@dharchitects.co.uk
1:50 @A3	david hughes architects
Feb' 13	
0437 762 P1	

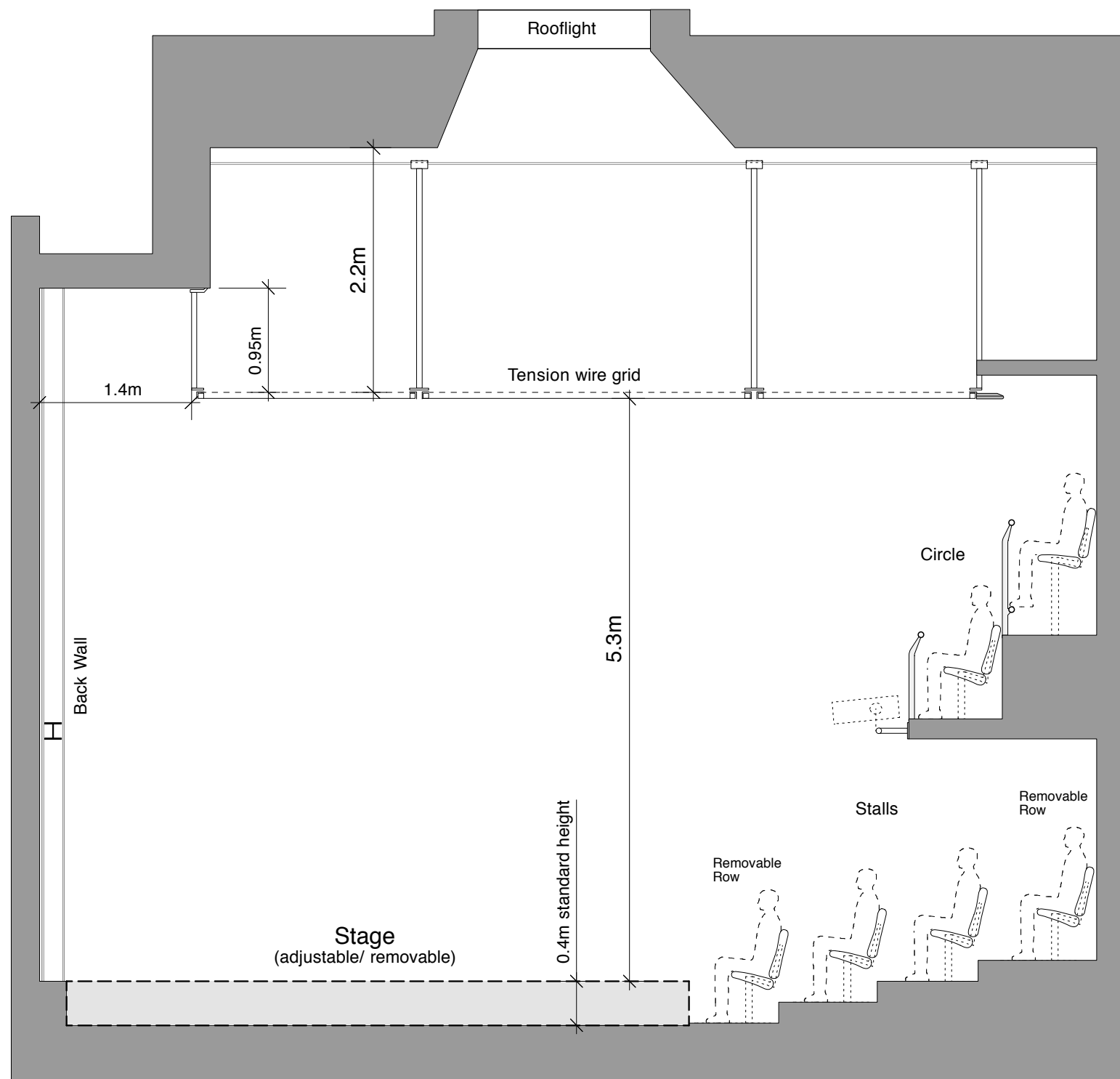

Cross Section
(Thrust 1 - Standard Stage configuration)

The Park Theatre, Clifton Terrace, N4	Studio 2 60 High Street Hampton Wick Surrey KT1 4DB
Park 200 Cross Section	T 020 8977 8108 W dharchitects.co.uk E mail@dharchitects.co.uk
1:50 @A3	david hughes architects
Feb' 13	
0437 763-A P1	

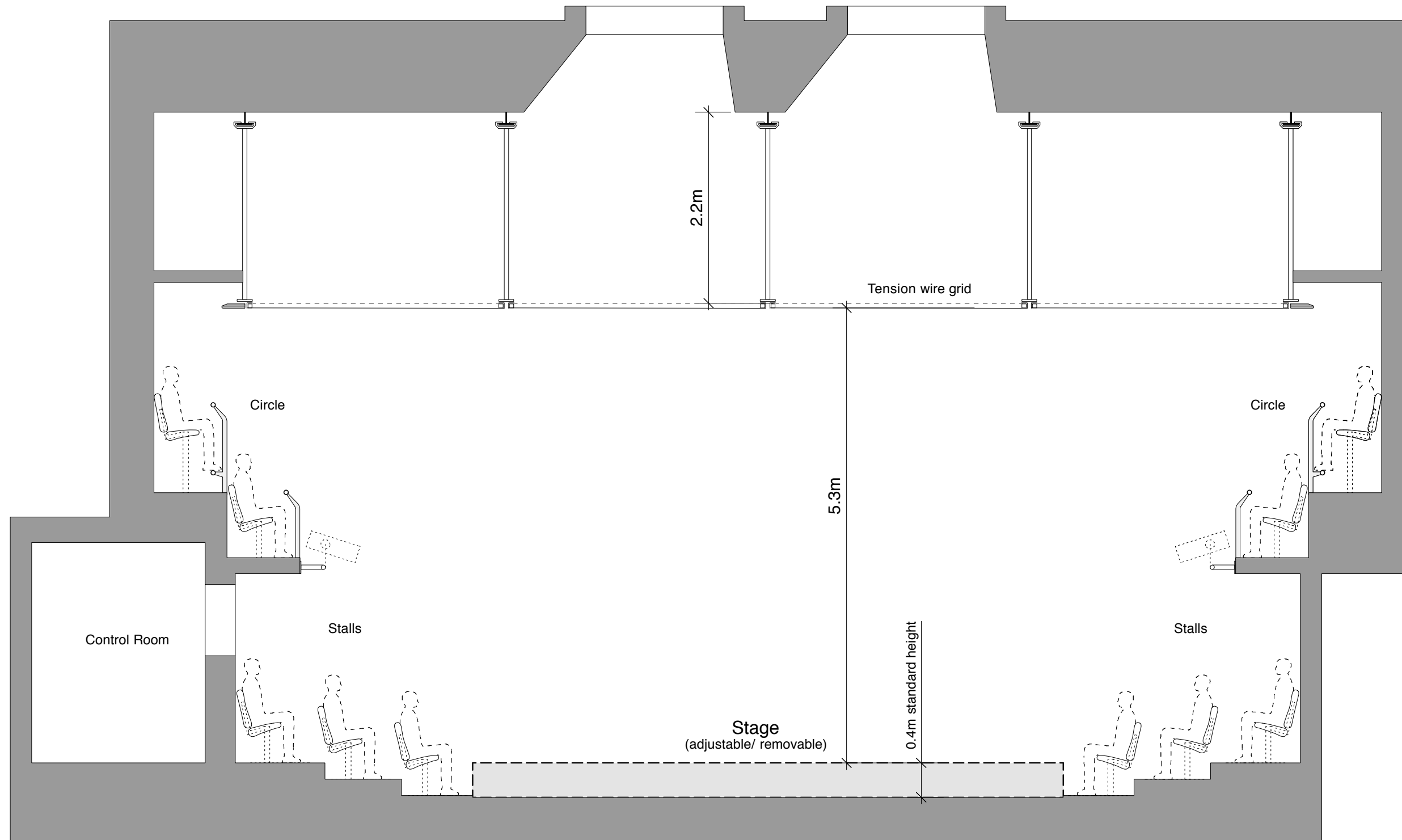

Long Section
(Thrust 1 - Standard Stage configuration)

The Park Theatre, Clifton Terrace, N4	Studio 2 60 High Street Hampton Wick Surrey KT1 4DB
Park 200 Long Section	T 020 8977 8108 W dharchitects.co.uk E mail@dharchitects.co.uk
1:50 @A3	
Feb' 13	
0437 764-B P1	david hughes architects